

REV. NO.	DESCRIPTION	DATE

ITEM	UNIT	PHASE I			PHASE II		
		APPROACH SLAB NO. 1	APPROACH SLAB NO. 2	TOTAL	APPROACH SLAB NO. 1	APPROACH SLAB NO. 2	TOTAL
		CLSM BACKFILL	C.Y.	28	28	56	28
APPROACH SLAB	S.Y.	42.8	42.8	85.6	42.8	42.8	85.6
MECHANICAL SPLICES	EA.	20	20	40			
RAPID CURE JOINT SEALANT	L.F.	19.0	19.0	38.0	19.0	19.0	38.0
WATER REPELLENT (VISUALLY INSPECTED)	S.Y.	7	7	14	37	36	73

① EPOXY COAT OR GALVANIZE MECHANICAL SPLICES SHOWN. PROVIDE #4 EPOXY COATED REBAR WITH A MINIMUM LAP LENGTH OF 2'-0" FOR EACH MECHANICAL SPLICE AND LAP THEM WITH AT BARS (BOTTOM). INCLUDE ALL COST FOR THE EPOXY COATED REBAR, LABOR AND INCIDENTALS IN THE CONTRACT UNIT PRICE OF "MECHANICAL SPLICES".

APPROACH SLAB BAR LIST				
ONE SHOWN, FOUR REQUIRED				
MARK	SIZE	NO.	FORM	LENGTH
EPOXY COATED REINFORCING				
AL1	#4	22	STR.	18'-10"
AL2	#8	42	STR.	18'-10"
AT1	#4	40	STR.	19'-11"

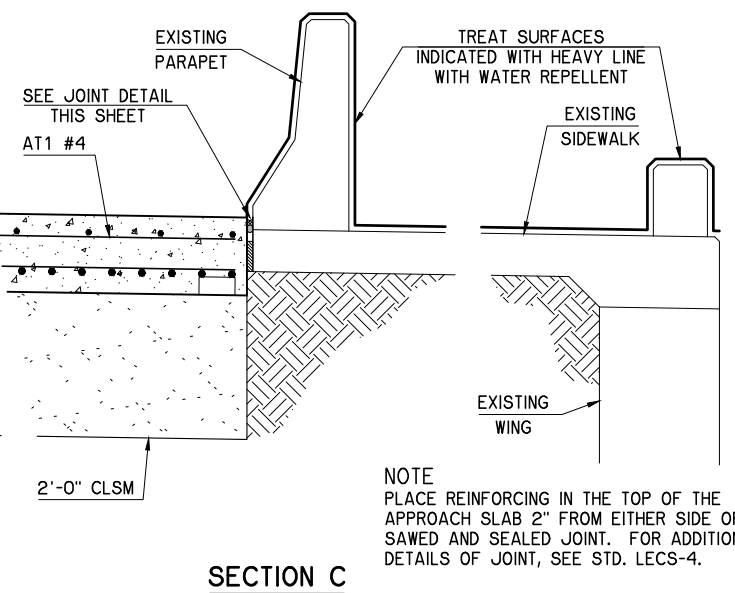
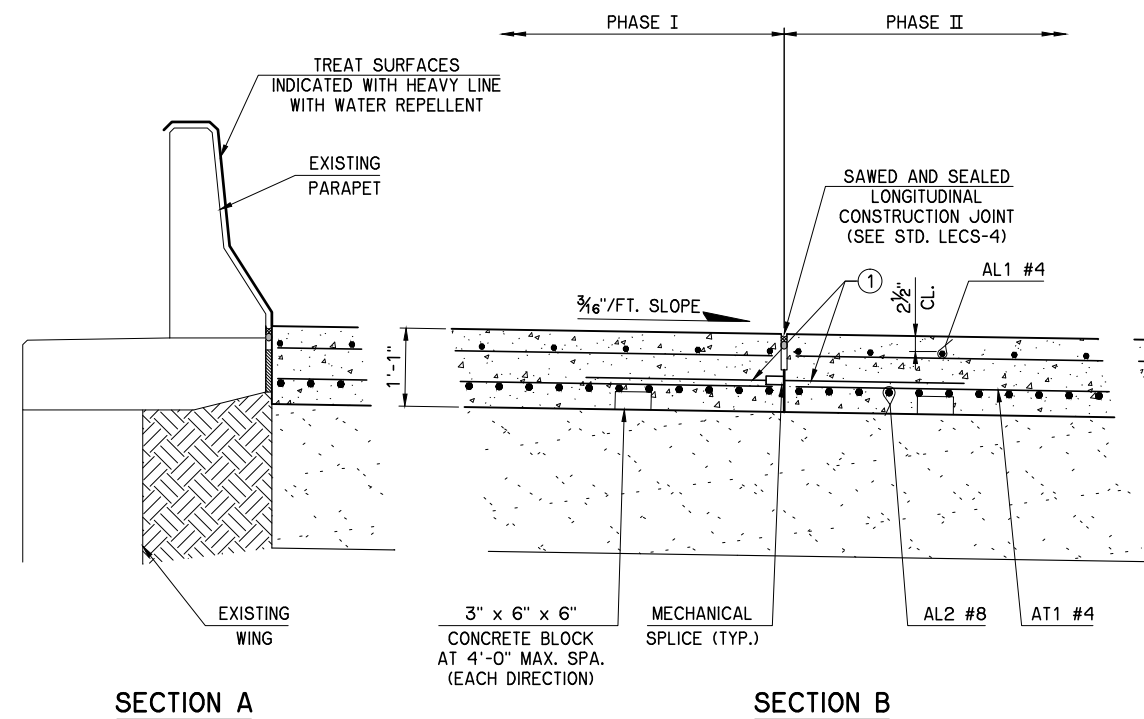
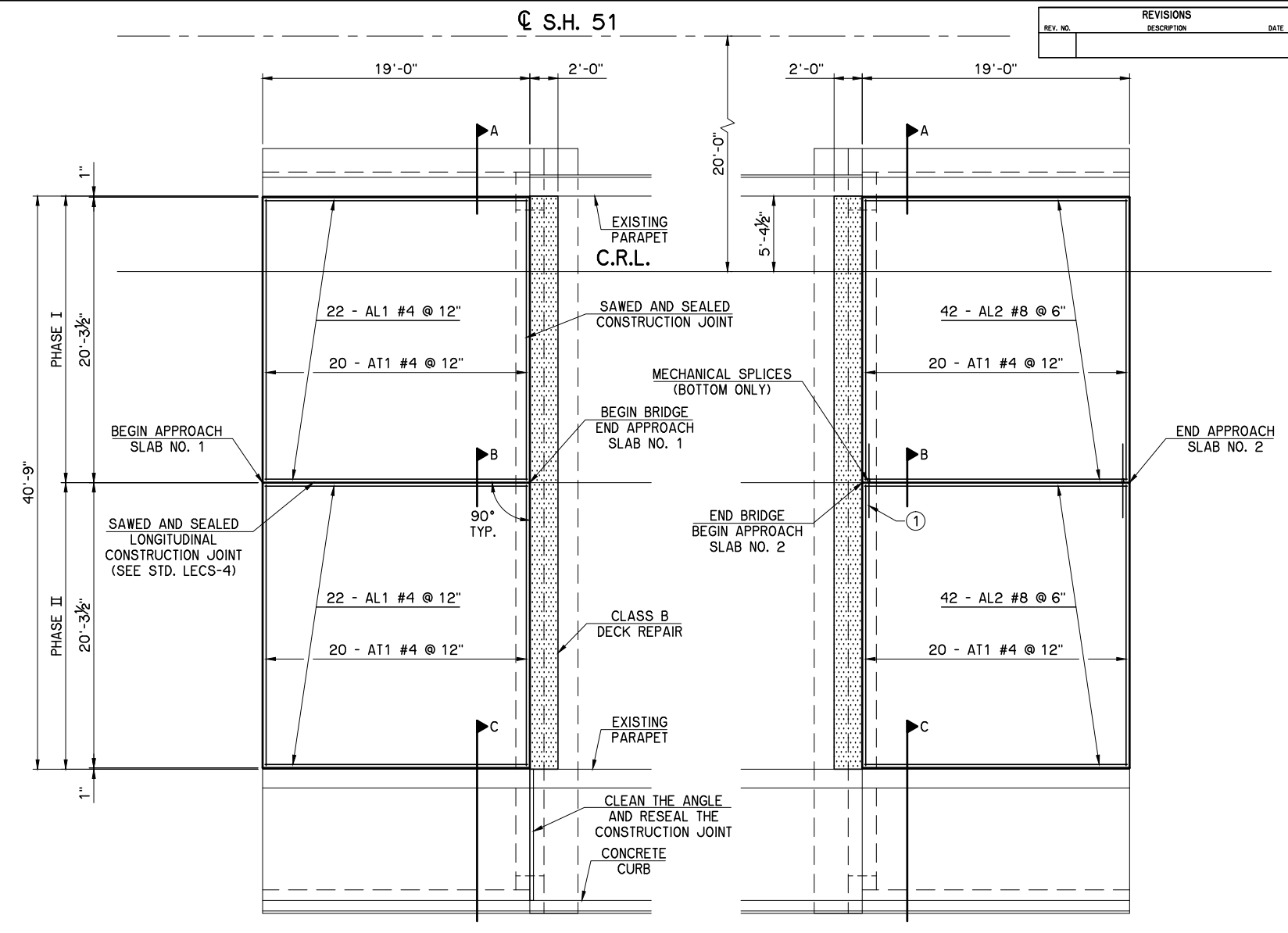
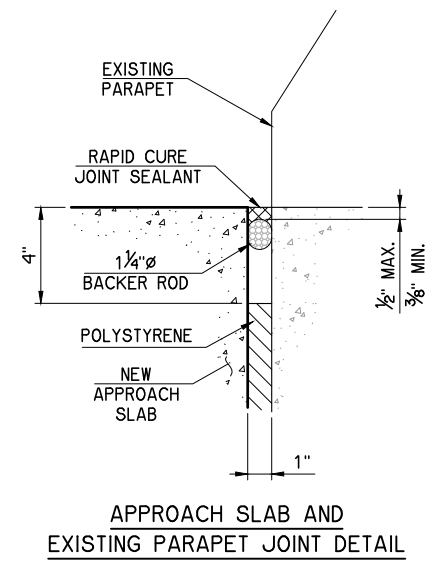

NOTE: FOR ADDITIONAL DETAIL OF APPROACH SLAB AT ABUTMENT SEE LONGITUDINAL SECTION ON SHEET 27.

SH 51 NB OVER ARKANSAS RIVER	TULSA COUNTY	Design	ADT
APPROACH SLAB DETAILS		Detail	FEZ
		Check	ADT
		WHITE ENGINEERING ASSOCIATES	
STATE OF OKLAHOMA	DEPARTMENT OF TRANSPORTATION	JOB PIECE NO. 31358(04)	SHEET NO. 35